

**6th Annual
Indiana University School of Medicine
Education Day Program**

Hine Hall Conference Center

Friday, April 25, 2025

8:00 am – 5:00 pm

“Leadership and Mentorship in Medical Education”



INDIANA UNIVERSITY
SCHOOL OF MEDICINE

9:00 – 9:05 AM: WELCOME FROM DEAN ALLEN



Bradley Allen, MD, PhD
Executive Associate Dean
(Interim)
Educational Affairs
IUSM

Bradley Allen became the interim Executive Associate Dean for Educational Affairs in the fall of 2024, having been Senior Associate Dean for Medical Student Education since 2015. He’s also the D. Craig Brater Professor of Professionalism and Professor of Clinical Medicine and Infectious Diseases. He joined IUSM faculty in 2000 and practices Infectious Diseases and HIV care at the Roudebush VA Medical Center. He is a native Iowan, farm-boy, and first-generation university graduate. Brad is a University of Iowa graduate, with an MD/PhD in microbiology and later a fellowship in Infectious Diseases. He completed residency in Internal Medicine at Baylor College of Medicine in Houston. He is co-PI on the INdiana Primary care Advancement in Clinical Training (INPACT) federal grant from HRSA to improve primary care training for underserved communities and vulnerable populations, expand recruitment of trainees and grow clinical training opportunities in underserved communities around Indiana.

12:00 – 12:45 PM: KEYNOTE SPEAKER



Katherine Hiller, MD, MPH
Associate Dean and Director
IUSM - Bloomington

Dr. Hiller is the associate dean and director of the IU School of Medicine Bloomington campus. She is a tenured professor of emergency medicine and holds the James A. Caplin Chair of Medicine. She is also a practicing emergency physician at the IU Health Bloomington hospital and chief academic officer for the South Region of IU Health. Dr. Hiller has been involved in undergraduate, graduate and continuing medical education; faculty development; and mentoring programs at the IU School of Medicine. Dr. Hiller has extensively published high-quality medical education research, presented at numerous conferences, served as a medical expert for local media and acted as a principal investigator or collaborator on several grant-funded projects. Her educational work has included research around assessment in the classroom and clinical environments, programmatic assessment, curriculum development and faculty development and leadership. She has served on the boards of many national organizations, including the Clerkship Directors in Emergency Medicine, the National Board of Medical Examiners, the Association of American Medical Colleges and the American Board of Emergency Medicine. She is a proud wife and mother of two children, and while medicine is not a popular topic of conversation at the Hiller household, education and math are favorite subjects for the entire family.

**6th IUSM Education Day Agenda
Hine Hall, IU Indianapolis Campus
Friday, April 25th, 2025**

8:00-9:00 am	Hine Hall Slate Foyer	Registration
9:00-9:05 am	Hine Hall Auditorium	Welcome from Brad Allen, MD, PhD <i>Interim Executive Associate Dean Educational Affairs</i>
9:05-9:50 am	Hine Hall Auditorium	1 st Selected Oral Presentations
9:50-10:00 am		Break
10:00-10:45 am	Hine Hall Auditorium	2 nd Selected Oral Presentations
10:45-11:00 am		Break
11:00-11:45 am	Hine Hall (HH)	Concurrent Workshops <i>(HH Rooms 216, 222, 226, 231, 232, 236)</i>
11:45-12:00 pm		Break
12:00-12:45 pm	University Tower Ballroom	Lunch and Keynote Speaker <i>(Katherine Hiller, MD, MPH)</i>
12:45-1:00 pm		Break
1:00-1:45 pm	Hine Hall (HH)	1 st Concurrent Themed Oral Presentations: <ul style="list-style-type: none"> ■ <i>Creating Belonging in Medicine - Why Words Matter (HH Room 216)</i> ■ <i>Assessment (HH Room 219)</i> ■ <i>Wellness (HH Room 222)</i> ■ <i>Point of Care Ultrasound (HH Room 226)</i> ■ <i>Simulation (HH Room 231)</i> ■ <i>Artificial Intelligence in Medicine (HH Room 232)</i> ■ <i>Resident Patient Safety – I (HH Room 236)</i>
1:45-2:00 pm		Break
2:00-2:45 pm	Hine Hall (HH)	2 nd Concurrent Themed Oral Presentations: <ul style="list-style-type: none"> ■ <i>Graduate Medical Education (HH Room 216)</i> ■ <i>Biomedical Education (HH Room 219)</i> ■ <i>Simulation Center Collaborative Group (HH Room 222)</i> ■ <i>Regional Medical Campuses (HH Room 226)</i> ■ <i>Undergraduate Medical Education (HH Room 231)</i> ■ <i>Resident Patient Safety – II (HH Room 236)</i>
2:45-3:00 pm		Break
3:00-4:00 pm	Hine Hall Hallway	Poster Presentations <i>(1st floor)</i> Scholarly Concentration Poster Presentations <i>(2nd floor)</i>
4:00-5:00 pm	Hine Hall Auditorium Lobby	Reception and Certificates

9:05 - 9:50 AM

1st SELECTED ORAL PLATFORM PRESENTATIONS

HINE HALL AUDITORIUM

- **Evaluation of Altered Mental Status by Medical Students: How Does Bias Affect Decision Making?**
Malia Moore, Jonah Persinger, Rachel Day, Audrey Herbert, Dylan Cooper, Jennifer Deppen, Matthew Hays, Xiaochun Li, Ashley Satorius, Anna Bona, Katie Pettit
- **Medical Students Want Asynchronous Content. But Do They Watch It? A Comparison of Viewership and NBME Data.**
Payton Miller, Megan Rendina, Folasade Imeokparia, Lindsey Mossler, Katie Stanton
- **Factors Influencing Dictation Errors in Radiology Resident Reports: An Institutional Analysis**
Justin Smith, Grace Yedlicka, Allison Yang, Peter Gunderman
- **Curricular Mapping for Sexual Health Competencies**
Brenda Anak Ganeng, Stephanie Freed, Jessica Byram

9:50 – 10:00 AM

BREAK

10:00 – 10:45 AM

2nd SELECTED ORAL PLATFORM PRESENTATIONS

HINE HALL AUDITORIUM

- **Student Experiences on Required Regional Clinical Placements during Medical School**
Hannah O. Davis, Althea N. Kaminske, Cameron J. Edwards
- **Fostering Belongingness in Clerkships: Insights from Third-Year Medical Student Reflections**
Jessica Byram, Neil Mehta, J. Harry Isaacson, Richard Frankel
- **Enhancing Specialty Selection in Medical Education: A Scoping Review of Interventions in US Allopathic Medical Schools**
Anthony Shanks, Miriam Ramirez, Emily Walvoord, Judith Maddatu, Diana Arrocha, Bhavi Sarda, Amanda Benadaret, Debra Rusk
- **Needs Assessment of a Minimally Invasive Gynecologic Surgery (MIGS) Curriculum: Perspectives of Recent OB/GYN Graduates**
Leah Bode, Alexandra Dadrat, Sara Spielman, MaKayla Picklesimer, Colette Gnade, Adeoti Oshinowo

10:45 – 11:00 AM

BREAK

11:00 – 11:45 AM

CONCURRENT WORKSHOPS

HINE HALL

HH ROOM 216

- **Prompt Development 101 for Medical Educators**
Levi Dolan, Samar Khirallah, Andrew Cale, Anthony Shanks

HH ROOM 222

- **AI at IUSM**
Dave Hanson, Ben Steckler

HH ROOM 226

- **It's Never Too Early to Start: Let's Curate your Online Scholarly Presence for Residency Applications**
Hannah J. Craven, Anthony L. Shanks, Brandon T. Pieczko

HH ROOM 231

- **Building Future Educators: Designing and Implementing a Teaching Assistant Elective Course**
Katie Stanton-Maxey, Lindsey Mossler, Sade Imeokparia, Anne Skiles, Cassey Krupa, Megan Rendina

HH ROOM 232

- **Kudos! Faculty and Resident Teaching Development: A Carrot Approach**
Folasade Imeokparia, Meghan Rendina, Cassey Krupa, Anne Skiles, Lindsey Mossler, Katie Stanton-Maxey

HH ROOM 236

- **Building a Culture of Growth and Safety: A Workshop on Positive Reinforcement, Mistreatment, and Psychological Safety**
Adriano Sanjuan, Jay Kishor Akolkar, Francesca Christina Duncan

11:45 – 12:00 PM

BREAK

12:00 – 12:45 PM

LUNCH & KEYNOTE SPEAKER

UNIVERSITY TOWER BALLROOM

- **Keynote Speaker: Katherine Hiller, MD, MPH**
"Math is Perfect, Humans are Messy – My Journey in Medical Education"

12:45 – 1:00 PM

BREAK

1:00 – 1:45 PM

**1st CONCURRENT THEMED ORAL PRESENTATIONS
HINE HALL**

CREATING BELONGING IN MEDICINE – WHY WORDS MATTER [HH ROOM 216]

Session Leader: Matthew Holley, PhD

Additional Contributors:

- **An Equitable and Inclusive Language Workshop with Indiana LEND Trainees (Leadership Education in Neurodevelopmental Disabilities)**
Asna Asrar, Areeba Kara, Krista Longtin
- **Developing Relationship-Centered Communication and Allyship Skills via Active Learning Strategies**
Katherine Chartier, Rachel Kowal, Sarah Walsh, Matthew Holley
- **How do Internal Medicine Residency Program Websites Signal their Inclusion to Prospective LGBTQIA+ Applicants?**
Will Gribbin, Brittany Baker, Ellen Peterson, Brenda Anak Ganeng, Jessica Byram

ASSESSMENT [HH ROOM 219]

Session Leader: Kathy Zoppi, PhD

WELLNESS [HH ROOM 222]

Session Leader: Heather Kelker, MD

Additional Contributors:

- **Online Learning and Student Wellness in the Pre-clinical Curriculum**
Leslie A. Hoffman, Ann Jones, Lisa McTavish
- **The Mental Health and Well-Being of Residents and How They Relate to Program Specific Issues**
Nathan Sevilla, Alejandro Garcia, Zachary Wagner, Lorena Juarez, Paola Rodriguez, Lourdes Izaguirre, Javier Sevilla, Anna Pendrey

POINT OF CARE ULTRASOUND – POCUS [HH ROOM 226]

Session Leader: Rob Ferre, MD

Additional Contributors:

- **Evaluation of a Point of Care Ultrasound Active Learning Module for High School Student Outreach**
Victoria L. Gomez, Elizabeth R. Agosto, Andrew S. Cale
- **Establishing Competency in Point-of-Care Ultrasound in Nephrology Fellowship**
Morgan Marcuccilli
- **A Novel Approach to Point-of-Care Ultrasound (POCUS) Education: One-page Documents with Embedded E-Curriculum**
Nathan Markus, Adriano Sanjuan, Eric Osborn, Edwin Jackson
- **Development of a Point of Care Ultrasound Assessment Tool for Focused Cardiac Ultrasound**
Frances Russell, Robinson Ferre, Nicholas Seitz, Parker Lewis, Dani Brenner, Audrey Herbert

SIMULATION [HH ROOM 231]

Session Leader: Dylan Cooper, MD

Additional Contributors:

- **Assessing Surgical Skills Lab Instruction**
Yichuan Yan, Althea Kaminske, Maya Hunt, E. Matt Ritter, Dimitrios Stefanidis
- **Improving Fellow Research Study Design Skills and Confidence Through Gamification**
Anne Whitehead, Nathan Alves
- **Virtual Reality Empathy Training**
Dylan Cooper

ARTIFICIAL INTELLIGENCE IN MEDICINE [HH ROOM 232]

Session Leader: Anthony Shanks, MD

Additional Contributors:

- **Reimagining Anatomy Education with Generative AI: A Student-Centered Exploration**
Victoria L. Gomez, Margaret A. McNulty
- **Balancing Innovation and Ethics: Anatomy Students on Generative AI**
Victoria L. Gomez, Margaret A. McNulty
- **Evaluation of AI Narrative Feedback for Gross Anatomy**
Samar Khirallah, Andrew Cale, Levi Dolan, Kyle Robertson

RESIDENT PATIENT SAFETY - I [HH ROOM 236]

Session Leader: Tina Marie Schade-Willis, MD

Additional Contributors:

- **Analysis of Barriers and Perceptions to In-Hospital Incident Reporting by IU Trainees**
Emily Lyons, Sara Manning

1:45 – 2:00 PM

BREAK

2:00 – 2:45 PM

2nd CONCURRENT THEMED ORAL PRESENTATIONS

HINE HALL

GRADUATE MEDICAL EDUCATION [HH ROOM 216]

Session Leader: Jennifer Choi, MD

Additional Contributors:

- **Bridging the Research Gap: Developing Core Competencies and Research Culture in Internal Medicine Residency Training**
Mounir Al Gibbawi, Jennifer R. Hur, Sacha Sharp
- **Evaluating Resident Competency in Leading Neonatal Resuscitation using a Validated Tool**
Margaret Gegick, Sara Kane

- **Setting the Bar: Using EPAs to Define Competence for the Foundational Surgical Resident**
Maya L. Hunt, Payton M. Miller, Noosha Deravi, Dominique Doster, Yichuan Yan, Brianne Nickel, Dimitrios Stefanidis, E. Matthew Ritter
- **Effects of Trainees on Faculty Clinical Productivity**
Peter Gunderman, Mason Tippy, Richard Gunderman, Tyler Avery

BIOMEDICAL EDUCATION [HH ROOM 219]

Session Leader: Tom Hurley, PhD

Additional Contributors:

- **Introducing a Professional Development Skill Building Platform into a Biomedical Sciences Graduate Program Curriculum in Pharmacology**
Elizabeth Yeh

SIMULATION CENTER COLLABORATIVE GROUP [HH ROOM 222]

Session Leader: Dimitris Stefanidis, MD, PhD

REGIONAL MEDICAL CAMPUSES [HH ROOM 226]

Session Leader: Matthew Tews, MD

Additional Contributors:

- **Scholarly Concentrations Program: Contributing to Student Satisfaction**
Deborah Birnbaum, Anthony Masseria, Michelle Marie Polanco

UNDERGRADUATE MEDICAL EDUCATION [HH ROOM 231]

Session Leader: Paul Ko, MD

Additional Contributors:

- **Exploring First Year Medical Student Perceptions of a Vertically Integrated Anatomy Curriculum in Medical Education**
Robert Becker, Jessica Byram
- **Can the Hidden Curriculum of Overnight Call for Third-Year Surgery Clerkship Students be Fulfilled during Daylight Hours?**
Noosha D. Deravi, Maya L. Hunt, Payton M. Miller, Katie Stanton-Maxey
- **De-Mystifying the Surgery Clerkship Grade: Enhancing Transparency and Promoting Personal Improvement**
Folasade Imeokparia, Meghan Rendina, Casey Krupa, Anne Skiles, Lindsey Mossler, Katie Stanton-Maxey

RESIDENT PATIENT SAFETY - II [HH ROOM 236]

Session Leader: Tina Marie Schade-Willis, MD

2:45 – 3:00 PM

BREAK

3:00 – 4:00 PM

POSTER PRESENTATIONS

HINE HALL HALLWAY - 1ST FLOOR

ED 1. Perceptions, Experiences, and Attitudes of Health Professions Students in a Cadaver-Based Human Anatomy Educational Experience

Jose Mas, Baraka Muvuka, Michelle Beck, Caroline Boyle, Ronni Allen

ED 2. Development and Initial Evaluation of a Gross/Embryo Q-bank for Human Structure

Polly Husmann, Kyle Robertson, Leslie Hoffman, Abigail Sondreal, Brandon Flom, Tracy Vargo-Gogola

ED 3. Detergent, Foam & Candy: Evaluating a Novel Transition to Residency Cadaver Skills Curriculum

Maya L. Hunt, Payton M. Miller, Madeline B. Krusing, Noosha D. Deravi, Lindsey P. Mossler, Katie J. Stanton-Maxey

ED 4. Impact of an Introductory Session on Students' Attitudes and Emotions Toward Anatomical Donors and Cadaveric Dissection

Samar Khirallah

ED 5. Diagnosing the First Patient: Integrating Histopathology into an Undergraduate Gross Anatomy Course

Megan Kruskie, Jess Byram, Kyle Robertson

ED 6. Student Use and Perceptions of a Human Structure Anki Flashcard Deck

Leah J. Peipert, Abigail Sondreal, Brandon Flom, Kyle Robertson, Ike Izah, Leslie Hoffman, Polly Husmann, Tracy Vargo-Gogola

ED 7. The State of Human Skeletal Remains at U.S. Medical Schools

Sabrina Woods, Jessica Byram

ED 8. A Mini-Immersion Workshop in the Department of Pathology and Laboratory Medicine: An Intervention Designed to Address the Experiential Gap of Medical Students to the Field of Pathology

Rachel P. Kowal, Komal Kochhar, Krista. J. Longtin, Matthew Kuhar, Anne Nguyen, Adeyinka Akinsanya, J.P. Lavik, Michael Feldman, Nicole LePage, Jessica Muldoon, Halimat Olaniyan, Joshua Kocemba

ED 9. The Peer Evaluation Tool: A Concurrent Validity Assessment

Jessica Byram, Elizabeth Agosto, Kyle Robertson

ED 10. Program-Weighted Situational Judgement Tests: Making Holistic Review More Evidenced Based and Manageable

Noosha Deravi, Madeline M. Blackwell, Brianne Nickel, Payton M. Miller, Maya L. Hunt, Dimitrios Stefanidis, E. Matthew Ritter

ED 11. Setting Standards for a Foundational Oral Exam within a Competency-Based Program of Assessment

Noosha Deravi, Christopher M. Thomas, Madeline Blackwell Krusing, Maya L. Hunt, Payton M. Miller, Dominique Doster, Yichuan Yan, Dimitrios Stefanidis, E. Matthew Ritter

ED 12. Examination of Procedures Performed by M3s During the IUSM Anesthesia Clerkship

W. Andrew Harvey, Lindsey N. Grabek, Tanna J. Boyer, Timothy T. Webb

ED 13. The Evolution of Surgical Approaches to Brachial Plexus Injury

Barnabas Obeng-Gyasi, Piiamaria Virtanen, Jackson Griffith-Linsey, Michael Sundahl, Jason Schwab, Jamie Bradbury

ED 14. Extracurricular Skills Development Through Neonatal Care Innovations

Carl Russell III, Neal Patel, Damen Wilson, Ben Johnson, Andrew Sivaprakasam, Conner Earl

ED 15. Medical Student Knowledge of Indiana Abortion Policy in the Post-Dobbs Era

Myanna Cook, Anslyn Freije, Anna Pressel, Erin O'Farrell, Anthony Shanks, Amy Caldwell

ED 16. Moral Formation in Medical Education: A Framework

Afsheen Mansoori, Aishat Audu, Richard Gunderman

ED 17. Identifying Student Perspectives and Needs on Institution-based Research Experiences

Noah Burket, Luke Jackson, Marie Karam, Ashlyn Morris, Anne Nguyen, Brittney-Shea Herbert

ED 18. Scholarly Medical Student Engagement in Public Health Research

Amanda D. Benaderet, Deborah R. Birnbaum, William M. Tierney

ED 19. Acute Compartment Syndrome: A Case Report for Pre-Clinical Students' Learning & Associated Small Group Worksheet

Kyle Callahan

ED 20. Utilization of Lecture-Based and Simulation-Based Teaching of Trauma-Informed Care in First-Year Medical Curriculum

Elizabeth Kerns, Elsie Gasaway, Geneva Baumberger, Polly Husmann

ED 21. Effects of Structured Curriculum and Simulation-Based Interventions on Pediatric Endoscopy Education

Brett J. Hoskins

ED 22. Additional Validity Evidence for the New ENDO Mentor Suite and its Use in the Fundamentals of Endoscopic Surgery Examination

Noosha D. Deravi, Payton M. Miller, Maya L. Hunt, Jessica Mischna, Jose M. Martinez, Eric Pauli, E. Matthew Ritter

ED 23. Development of a Point-of-Care Ultrasound Training Curriculum the IUSM Anesthesia Clerkship

Timothy T. Webb, Tanna J. Boyer, Lindsey Grabeck, W. Andrew Harvey, Johnny Cartwright, Chris Moore, Melissa A. Nobbe, Sally A. Mitchell

ED 24. Developing a Musculoskeletal Ultrasound Curriculum for Internal Medicine Residents

Rachna Chaudhari, Reid Wilson, Meredith Ventura

ED 25. Leveraging Advanced Cardiac POCUS in the Diagnosis of Infective Endocarditis with Negative Conventional Imaging: A Case Report

Adriano Sanjuan, Heather Andrade, Alyson Bundy, Philip Clapham, Nathan Markus, Daniel S. Brenner, Irina K. Hariri, Edwin Jackson

ED 26. Gastric Ultrasound Education: Participant Survey Data from a Statewide Gastric POCUS Workshop

Nicole Bianca Libiran, Azam Mohammed, Brandon Tanner, Tanna Boyer, Senthil Packiasabapathy

ED 27. C.A.M.E.R.A.: Communication Assistance and Mentoring in Electronic Residency Applications

Erica Swanson, Aniffa Kouton, Deja Miller-Brooks, Wen J. Chen, Corinna Yu

ED 28. Impact of Residency Curriculum and Individual Resident Characteristics on Primary Care Careers

Lauren Carpenter, Michael Wilson

ED 29. Improving Cancer Screening Rates Through Resident-led Teaching Initiative at a VA Primary Care Clinic

Paresh Kumar, Kassy Kneen, Trevor Lehr

ED 30. A Workshop Series for New Program Directors - Lessons Learned?

Christen Dilly, Jennifer Choi, Phillip Pham

ED 31. Predicting Surgical Leadership: More Than Institutional Pedigree

Maya L. Hunt, Qais AbuHasan, Noosha Deravi, Payton Miller, Hermona Abera, Keith Makhecha, Rafia Durrani, Brianne Nickel, Dimitrios Stefanidis, E. Matthew Ritter

ED 32. Know Before You Go: Evaluating the Utility of Pre-Departure Training for Internal Medicine Residents Prior to an International Elective

Grace Arias, Goble Gretchen, Corinne Thornton

ED 33. Assessment and Implementation of Preconception Training for Internal Medicine Residents

Allison Knoedler, Erica Swanson

ED 34. Video-Based Assessment for Laparoscopic Fundoplication: Validity Evidence for Rater Training among Surgical Trainees

Noosha D. Deravi, Dylan Grisell, Aimee K. Gardner, Marina S. Kurian, Anna R. Ibele, Nova Szoka, Linda Schultz, Liane S. Feldman, E. Matthew Ritter

ED 35. Best Practices for Balancing Inquiry and Efficiency on a Gastroenterology Consult Survey: Outcomes of a Delphi Survey

Natashay J. Bailey, Christen Dilly

ED 36. Exploring Ownership Structures in Radiology Residency

Molli Fromke, Tina Ahmadi, Peter Gunderman

ED 37. Reappraising Resident Hematopathology Training at Indiana University

Halimat Olaniyan, Adeyinka Akinsanya, Rohit Gulati

ED 38. Effect of Pre-clinical Patient Exposure on US Medical Student Bias Towards Mental Health

Lauren Bryant, Alyssa Smith, Micah Iticovici, Lindsey d'Arnaud, Donbing Lai, Nermeen El-Araby, Ifeoluwa Ladapo, Mario Padron, Nazli Tunali, Sydney Waller, Joseph McCann, Martin Palwecki

ED 39. Mission Impossible: Program Directors on Improving Resident Well-Being

Maya L. Hunt, Daniela Amórtégui, Ray T. Ramirez, Jr., Natalia I. Mackiewicz, Amy L. Holmstrom, Karl Y. Bilimoria, Julie K. Johnson, Yue-Yung Hu

ED 40. Harnessing Applied Improvisation to Restore Empathy and Connection in Stressed Emergency Departments (HarRiED)

Elizabeth Weinstein, Jeff Heerdink-Santos, Krista Longtin

ED 41. Year 1 Academic Outcomes for Medical Students Participating in a Pre-Matriculation Program

Althea Kaminske, Jasmine Johnson, Chemen Neal

ED 42. Performance in Year 1 Anatomy Course for Medical Students Participating in a Pre-Matriculation Program

Jasmine Johnson, Althea Kaminske, Jessica Byram, Margaret McNulty, Chemen Neal

ED 43. Accommodating a Student with Hearing Impairment in Pre-Clinical Medical Education

Angelika I. Martin, Leslie A. Hoffman, Abigail Russell

ED 44. Family Planning Exposure on the OBGYN Clerkship in the Indiana Post-Dobbs Era

Myanna Cook, Anslyn Freije, Anna Pressel, Erin O'Farrell, Anthony Shanks, Amy Caldwell

ED 45. Improving Health and Well-Being of Older Adults in Underserved Communities: A Global Perspective

Anna Pendrey, Paola Castellanos, Lorena Juarez, Paola Rodriguez, Hector Mendoza, Lourdes Izaguirre, Nathan Sevilla, Mariela Sanchez, Alejandro Garcia, Javier Sevilla

ED 46. Building the Foundation: Assessing Health Literacy in Santa Cruz de Yojoa, Honduras

Alexa Engel, Lesbin Javier Velsásquez Lopez, Sharon Joseph, Jacob Olson

ED 47. IUSM Continuing Education in Healthcare Professions (CEHP) Fostering Cross-Departmental Collaboration Through Innovative Specialized Education Design

Breann Bauer, Rima Patel, Kim Denny, Jennifer E. Schwartz

ED 48. CEHP Program-Based Analysis of Accreditation Evaluation Criteria

Kim Denny, Jeff Lawley, Jennifer Schwartz

3:00 – 4:00 PM

SCHOLARLY CONCENTRATION POSTER PRESENTATIONS

HINE HALL HALLWAY - 2ND FLOOR

SC 1. Psychosocial Barriers to Equitable Food Access: A Qualitative Analysis of Food Pantries in Northern Indiana

Christopher J. Abrinko, Morgan C. Lain, Mahmoud D. Al-Fadhli, Caymah F. Dennis, Madeline G. Andrews, David Lassen

SC 2. Sociodemographic Disadvantaged Adolescent Attitudes on Healthy Lifestyle Education: Variances with Career Choice

Jocelyn Chang-Stroman, Gionté Mason, Amy Han, Tatiana Kostrominova

SC 3. Association of Socio-Demographic Factors and Social Determinants of Health with Physical Activity Level in Patients with Disabilities

Austin Clark, Baraka Muvuka, Jonathan Guerrero, Joshua Mangum

SC 4. Food Pantry Nutritional Food Acquisition and Distribution Assessment in the Greater St. Joseph Country Area

Mackenzie Johnson, Joshua Scott, JR Bales, Claire Harper

SC 5. Socio-Demographic and Behavioral Predictors of Ophthalmic Readmissions in Northwest Indiana

Grace Armstrong, Neon Calumpang, Jonathan Guerrero, Baraka Muvuka

SC 6. Impact of Social Determinants of Health on Stroke Severity in the Northwest Indiana Region

Jacobus Barnard, David Lin, Grace Armstrong, Neon Calumpang, Miranda Cash, Amy Han

SC 7. Social Determinants of 30-Day Readmissions in Congestive Heart Failure: The Role of Food Insecurity

Alison Blodgett, Jonathan Guerrero, Baraka Muvuka

SC 8. Impact of Race and Industry on Stroke Incidence on Patients in Northwest Indiana – A Report to Advocate for Targeted Community-Based Interventions

Miranda M. Cash, Sahar A. Abdullah, Amy Han

SC 9. Social Determinants of Health and Their Effects on Readmission and 30-Day Readmission in Patients with a History of Cardiovascular Interventions

Baraka Muvuka, Jonathan Edward Guerrero

SC 10. Social, Demographic, and Behavioral Determinants of Prolonged Hospital Stay and Readmissions of Postoperative Complications in an Urban Acute Care Hospital

Alexis Dres, Skyler Thompson, Maggie Sullivan, Baraka Muvuka, Jonathan Guerrero, Joshua Mangum, Kyle Gosporadek

SC 11. The Psychological Costs of Incarceration: Exploring the Development and Consequences of Post-Incarceration Syndrome

Ashley Egler, Elizabeth Nelson

SC 12. Decreased Racial Disparities in Sepsis Mortality after an Order Set–Driven Initiative: An Analysis of 8151 Patients

Maria L. Fernandez Olivera, Carl Pafford, Thomas Lardaro, Steven K. Roumpf, Michele Saysana, Benton R. Hunter

SC 13. Impact of Social Determinants of Health on Stroke Severity in the Northwest Indiana Region

Jacobus Barnard, David Lin, Grace Armstrong, Neon Calumpang, Miranda Cash, Amy Han

SC 14. Adult-Onset Cystic Fibrosis in a Spanish-Speaking Immigrant: Diagnostic Challenges and Barriers to Care

Alexa Mederos, Evelyn Crowley, Katie Rusiniak, Elijah Williams, Maria Parker Spector Robles

SC 15. Social Determinants of Inequities in Neurodegenerative Disease Readmissions in Northwest Indiana: An Advocacy Opportunity

Neon Calumpang, Grace Zhou Armstrong, Jonathan Guerrero, Baraka Muvuka, Kyle Gosporadek

SC 16. Cognitive and Behavioral Problems in Children with Uncomplicated and Asymptomatic Malaria in Low- and Middle-Income Countries: A Systematic Review and Meta-Analysis

Andrew Ssemata, Melissa Thomas, Paul Bangirana, Noeline Nakasujja, Ziyi Yang, Josey Noel, Chandy John, Megan McHenry

SC 17. Clinician Perspectives on Barriers and Facilitators to Providing Medications for Opioid Use Disorder for Adolescents in Indiana: A Qualitative Study

Jayla Ruth, Samantha Wagner, Matthew Aalsma, Zachary Adams, Lauren Bell

SC 18. An Analysis of Telehealth in a Post-Pandemic Rural, Midwestern Community: Increased Comfort and a Preference for Primary Care

Chase Salmon, Kameron Bell, Robin Danek, Eric Reyes, Ellen Ireland

SC 19. Racial and Ethnic Disparities in the Receipt of Regional Anesthesia for Surgical Interventions: A Narrative Review

Angad Sidhu, Marianne Matthias

SC 20. A Quantitative Evaluation of Community-based Educational Programming on African American Infant Mortality

Sheila Abebe, Kalyn M. Renbarger, Jean Marie S. Place, Avery Dawes, Olivia Huffman, WaTasha Barnes Griffin, Gabriel Hall, Adam Kroot, Tracina Greenleaf

SC 21. A Review of Best Practices in Recruitment of Individuals for Qualitative Studies from Marginalized Populations

Evan Barnett, Gregory Carter, Tyte Julian

SC 22. Training, Effectiveness, and Barriers for Pharmacists in Implementing Tobacco Cessation Interventions during Vaccine Administration

David Randall, Haleigh Kampman, Nervana Elkhadragey, Katy Hilts

SC 23. Understanding Variability in Long-Term Psychological Adjustment of Prelingually-Deaf Young Adults Implanted During Childhood

William G. Kronenberger, Irina Castellanos, Morgan A. Kincaid, Rick F. Nelson, Charles W. Yates, Susan T. Sehgal, Allison M. Ditmars, Carolyn J. Herbert, David B. Pisoni

SC 24. Vaping Addiction and Preventative Education (V.A.P.E): An Assessment of Electronic Cigarette Smoking in Adolescents

John Strobel, Zachary McLain, Lynn Witty, Larry Fromm

SC 25. Collaborative Opportunities for Teachers to Increase Adaptability of School-Based Sexual Health Education

Natalie Myers, Alison Greene, Catherine Sherwood-Laughlin, Lisa Greathouse, Ivanka Simic Stanojevic, Angela Chow, Dechen Sangmo, Mika Baugh, Wendy Schroder, Jordyn Galyan

SC 26. Barriers to Medicaid Enrollment and Healthcare Access for Hispanic/Latinx Populations in Hamilton County, IN

Lauren Earhart, James Medernach, Niki Messmore

SC 27. Seeing Eye-to-Eye: The Ethical Dilemma of Medicaid Refusal in Pediatric Ophthalmology

Margaret Tharp, Emily Beckman, Jane Hartsock

SC 28. Time-Driven Activity-Based Costing Analysis in Total Knee Arthroplasty

Iyad Ali, Rory Sandberg

SC 29. Effects of Functional Myofascial Release Therapy on Shoulder Range of Motion in a Collegiate Pitcher: A Case Report

Ryan Heumann, Matthew Waltz, Marcel Garcia-Hosokawa, Arthur Chlebowski

SC 30. Exploring the Correlation Between Time to Total Joint Arthroplasty and Depression Diagnosis in Obese Osteoarthritis Patients Using Real-World Database

Keegan Leek, Meagan McNicholas, Michael S. Roscoe, Arthur L. Chlebowski

SC 31. Predictors of Mortality and Hospital Length of Stay in Older Hip Fracture Patients in a Rural Community

Gabrielle Lutz, Thein Zhu

SC 32. Complications and Outcomes Associated with Two-Stage Treatment of Periprosthetic Knee Infection

Jacob Thomas, Mary Ziemba-Davis, Leonard T. Buller, R. Michael Meneghini

SC 33. Social Deprivation Index and Outcomes After ST-elevation Myocardial Infarction

Aditya Belamkar, Asad Torabi, Joshua Davis, Wesley Anderson, Elizabeth Von Der Lohe, Richard Kovacs, Rolf Kreutz

SC 34. Comparison of Endotracheal Tube vs. I-Gel Placement during Cardiac Arrests in Rural and Urban Settings: An EMS Personnel Survey

Kameron Bell, Chase Salmon, Eric Reyes, Robin Danek, Ellen Ireland

SC 35. Impact of Anticoagulant and Antiplatelet Medications on Operative Cost in HoLEP Patients

Cameron McClaine, Thomas Murphy, Abigail Beard, Thomas Shelton, Marcelino Rivera

SC 36. Role of Heterozygous PAI-1 Deficiency in Pathological Aging in the Human Cardiovascular System

Allison Nelson, Douglas Vaughan, Benjamin Żywicki

SC 37. Maximal Oxygen Uptake and Coronary Artery Calcium Scores in Firefighters

Hallie Waters

SC 38. Using Botulinum Toxin for the Treatment of Gastroparesis (GP) Post Gastric Peroral Endoscopic Myotomy (GPOEM)

Amr Kais, Mohamed Al-Haddad

SC 39. Evaluating the Role of Pretherapy Scans in Post-Thyroidectomy Thyroid Cancer Management: Predictive Value, Management Impact, and Efficacy

Yousif Mukatash, Mark Tann

SC 40. Awake Endoscopy with Advanced Programming to Optimize Hypoglossal Nerve Stimulation

Troy Wesson, Mohamad Z. Saltagi, Shalini Manchanda, Stephanie Stahl, Yelena Chernyak, Noah Parker

SC 41. Deficiencies in Capacity Documentation for Against Medical Advice Discharges: A Retrospective Cross-Sectional Review

Justin Barnett, Erin Brown, Joseph Cooper, Alyssa Smith, Emily Holmes

SC 42. The Wastes of the Operating Room

Youngjun Woo, Jonathan Arnold

SC 43. Objective Assessment and Scoring of Parkinsonian Tremors using Wrist Sensor Technology

Megan Sullivan, Aditya A. Shanghavi, Oliwia Rentley, Sarah Elizabeth Zauber, Anne B. Sereno

SC 44. A Human iPSC model of Alzheimer's Disease-Associated Fractalkine Receptor Polymorphism to Assess Microglial Dysfunction

Kaylee D. Tutrow, Jade Harkin, Catia Gomes, Melody Hernandez, Teresa Gomez, Kang-Chieh Huang, Yue Fang, Chi Zhang, Kate Cowger, Stephanie Bissel, Shweta Puntambekar, Bruce T. Lamb, Jason S. Meyer

SC 45. Phenotyping a Variant Associated with Pontocerebellar Hypoplasia 1B: RNA-Protein Discordance in a Rare Neurodegeneration-Related RNA Exosome Mutation

H.R. Sagara Wijeratne, Avery Runnebohm, Whitney Smith-Kinnaman, Emma H. Doud, Stephane Pelletier, Amber L. Mosley

SC 46. Developing a Tool to Assess Needs of AYA Cancer Survivors in Southwest Indiana

Brittany Ritzman, Joseph Sakel, Precious Okoruwa, Bridget Hawryluk, Lisa Parks, Dustin Lynch, Courtney Moore, Andrea Kiser, Brandon Cockrum, Ryan Heumann, Ellen Denning, Sarah Doherty, Austin Fonseca, Tessa Hemmerlein, Olwen Menez, Abigail Miller, Jessica Miller, Taylor Prechtel, Ross Quick, Ibrahim Rehman, Anjali Sivamohan, Aditi Sood, Hope Tominack, Sarah Wiehe, Kara Garcia, Tammy Sajdyk

SC 47. The Impact of Covid-19 on Implantable Cardioverter Defibrillator Implantation in Heart Failure Patients with Reduced Ejection Fraction

Emily Ryan, Rebecca Sparks-Thissen, Adrian Singson

SC 48. Elevated Levels of PDGF-BB and VEGF are Associated with a Decreased Risk of Readmission or Death in Children with Severe Malarial Anemia

Mary Slaughter, Samina Bhumbra, Kagan Mellencamp, Ruth Namazzi, Robert Opoka, Chandy John

- SC 49. Fast-Fourier Transform - Transfer Function Analysis of Beat-to-Beat Finger Skin Blood Flux and Arterial Blood Pressure may provide New Insights into Cold-Induced Vasodilation**
Thad E. Wilson, John A. Stout, Kristen Metzler-Wilson
- SC 50. The Altered Vascular Endothelial Control of Facial Cutaneous Blood Flow in Rosacea**
C. Ungureanu, Megan Kube, Thad Wilson, Kristen Metzler-Wilson
- SC 51. Reanalysis and Reclassification of UBA2 Variants in Patient with Syndactyly, Polydactyly, Aplasia Cutis Congenita and Other Anomalies Reveals Diagnosis**
Khurram Liaqat, Kimberly Felipe, Kayla Treat, Molly McPheron, Erin Conboy, Francesco Vetrini
- SC 52. The Role of SHROOM3 in Congenital Heart Disease**
Grant Hammons, Ally Aldrich, Rebecca Douglas, Catherine Guilfooy, Nina J. Jain, Ashleigh McMullan, Princess Murray, Caelen Rathke, Mark Wakulchik, Ellen Voskoboynik, James B. Zwierzynski, Stephanie Ware, Matthew Durbin
- SC 53. UGT2B10 Variant Effects on Dexmedetomidine Metabolism Using Nicotine Studies**
Cassidy Hardin, Aislinn O'Kane, Sara Quinney
- SC 54. Examination of the Effects of Thrombopoietin Mimetic Peptide (TMP) and High-Fat Diet on Femur Fracture Healing**
Saveda K. Majety, Samuel Zike, Danielle E. Hanna, Caio de Andrade Staut, Vincent Alentado, Sarah Mostardo, Murad Nazzal, Rachel Blosser, Sonali Karnik, Patrick Mulcrone, Melissa A. Kacena
- SC 55. Synergy between Formal and Informal Business Education**
Abigail Beard, Yo Sup Kim, Richard Gunderman
- SC 56. Medical Student Attitudes Regarding Dual-Degree Programs**
Frank Dijak, Komal Kochhar
- SC 57. Preclinical Medical Student Perceptions of Two Exam Feedback Approaches**
Elsie Gasaway, Valerie O'Loughlin
- SC 58. Impact of Indiana University School of Medicine's Service-Learning Experience in the Dominican Republic on Medical Students**
Ethan Goins, Niki Messmore, Ray Munguia
- SC 59. Impact of Point-of-Care Ultrasound on Patient-Family Experience in a Pediatric Emergency Department: A Randomized Control Trial Assessment**
Samuel Gutierrez, Pamela Soriano, Frances Russell, Benjamin Nti
- SC 60. Celiac Disease in Medical Curriculum**
Elizabeth Kerns, Polly Husmann
- SC 61. Investigating Declining Physician Engagement in West-Central Indiana State Medical Association**
Brianna Lawrence, Luke Swartz, Robert Ehresman
- SC 62. Through a Different Lens: Assessing Patient and Clinician Diversity in Medical Education Clinical Practice Media**
McKenna Major, Stacey Dunham, Valerie O'Loughlin
- SC 63. Promoting Healthcare Careers for Minority Adolescents from the City of Gary**
Gionté Mason, Jocelyn Chang-Stroman, Amy Han, Tatiana Kostrominova
- SC 64. Exploring Motivations for a Career in Geriatrics**
Mary O'Connor, Kathleen Unroe, Joe Kotva

SC 65. A Mixed-Methods Study Assessing Experienced Basic Needs Insecurity in Medical Students

Oseme Precious Okoruwa, Keyshla Chacon Nieves, Niki Messmore

SC 66. Resident Participation in Rural Rotations in Emergency Medicine Residency Programs

Kayley Ryan, Aloysius Humbert, Christine Motzkus

SC 67. The Impetus for Physician Advocacy

Eli Schantz

SC 68. Pathway of Military Medical Advancements from the Field to Widespread Adoption

William Stanton

SC 69. Assessment of AI (Artificial Intelligence) Based Facsimile Sorting System

Gabriel Araya, Arthur Chlebowski

SC 70. Gender Bias in Artificial Intelligence-Written Letters of Reference for Otolaryngology Residency Candidates

Grace Young, Janice Farlow, Heather Edwards, Linda Yin, Rasha Patel, Marianne Abouyared, Alexandra Kejner

SC 71. Competition and Collaboration in Medical School: Comparing Pass-Fail and Graded Systems

Tyler Dietzel, Blake Jarosinski, Brianne Brenneman

4:00 – 5:00 PM

RECEPTION & CERTIFICATES

HINE HALL AUDITORIUM LOBBY

PLANNING COMMITTEE

Komal Kochhar, MBBS, MHA (Chair)

Leslie Hoffman, PhD

David Rodgers, EdD

Dimitrios Stefanidis, MD, PhD

Bradley Allen, MD, PhD

ACKNOWLEDGEMENTS

Continuing Education in Healthcare Professions (CEHP): Heather Hollcraft and CEHP Team
Research in Medical Education (RIME) Team

SPECIAL THANKS

To IUSM faculty who served as abstract reviewers

Continuing Medical Education Learner Information

Course Objectives

- Identify examples of best practices in medical education
- Recognize the current approaches to assessing and evaluating learners
- Describe how educational outcomes data can be presented and published
- Network and collaborate with educators from other IUSM departments and campuses

Accreditation Statement



JOINT ACCREDITATION™
INTERPROFESSIONAL CONTINUING EDUCATION

In support of improving patient care, Indiana University School of Medicine is jointly accredited by the Accreditation Council for Continuing Medical Education (ACCME), the Accreditation Council for Pharmacy Education (ACPE), and the American Nurses Credentialing Center (ANCC), to provide continuing education for the healthcare team.

Physicians

Indiana University School of Medicine designates this live activity for a maximum of 5.5 *AMA PRA Category 1 Credits™*. Physicians should claim only the credit commensurate with the extent of their participation in the activity.

University Tower

FIRST FLOOR

Hine Hall

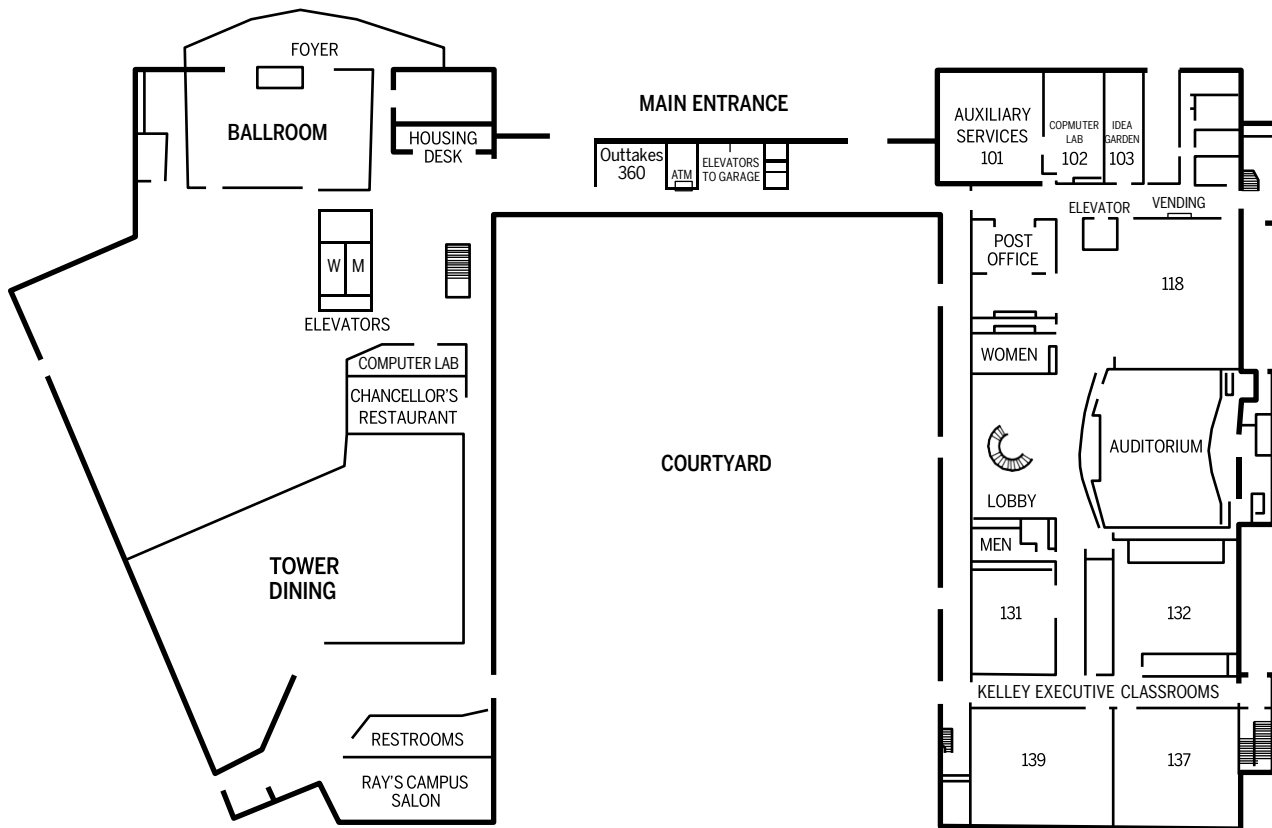

University Tower

SECOND FLOOR

Hine Hall

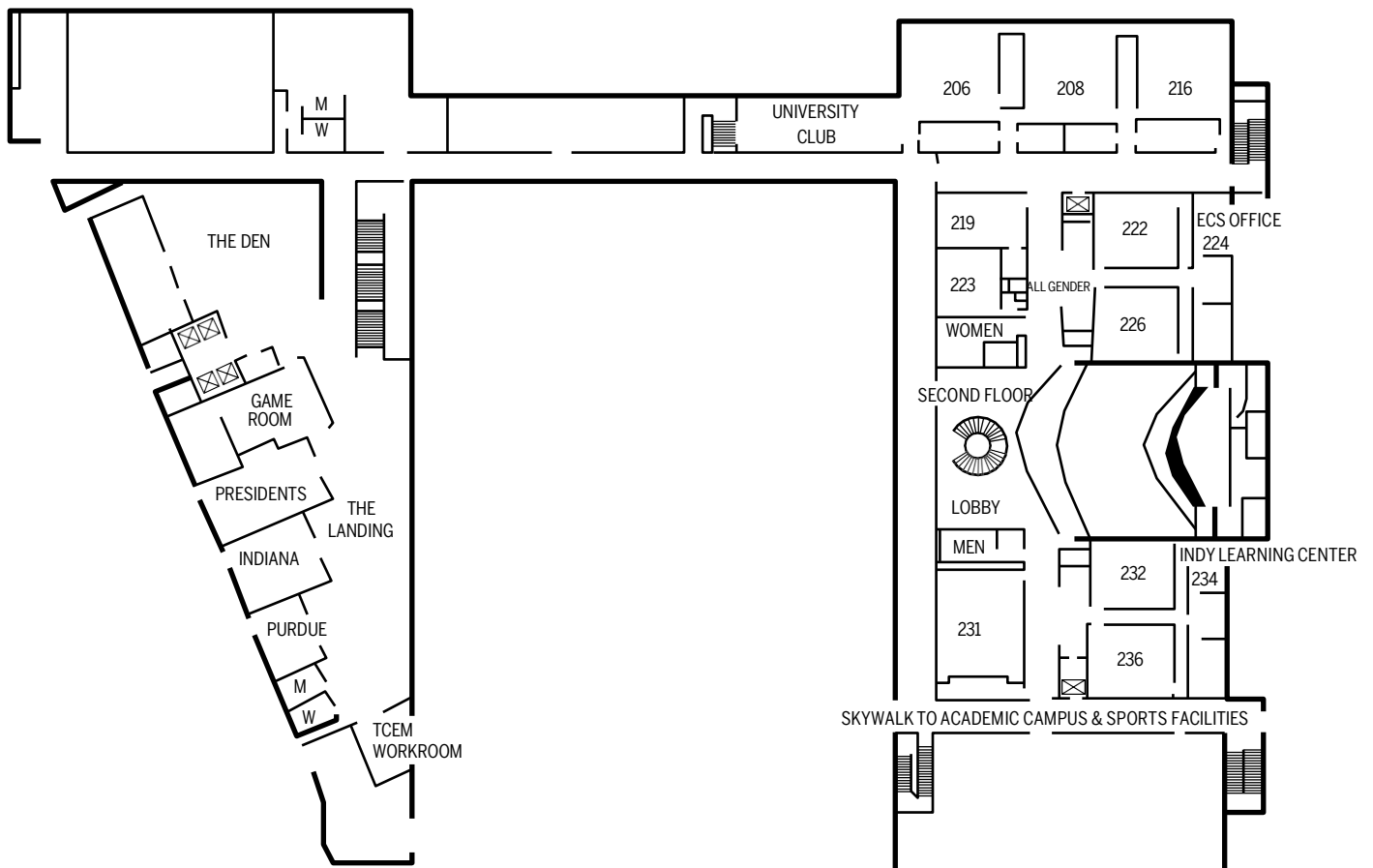

Follow us on 

#IUSMEDDay2025



INDIANA UNIVERSITY
SCHOOL OF MEDICINE